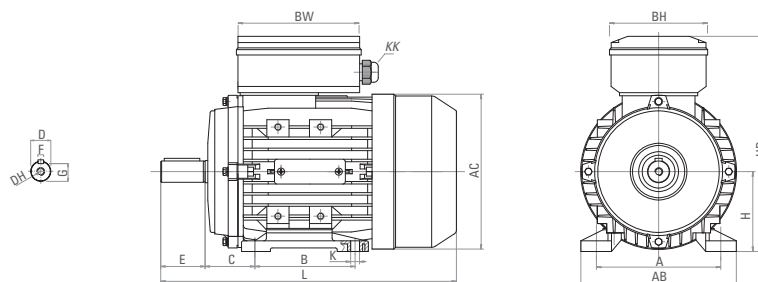

◆ 8.5 6M 6L monofase / single-phase motor

56-112 B3

**B3**

	A	AB	B	C	K	AC	HD	D	DH	E	F	G	H	KK	L	BW	BH
56-100 B3 ▶ 6M																	
56	90	108	71	36	5.8X8.8	115	156	9	M3X8	20	3	7.2	56	M16X1.5	192	116	92
63	100	120	80	40	7X10	130	179	11	M4X10	23	4	8.5	63	M16X1.5	212	116	92
71	112	132	90	45	7X10	145	194	14	M5X12	30	5	11	71	M20X1.5	240	116	92
80	125	157	100	50	10X10	165	223	19	M6X16	40	6	15.5	80	M20X1.5	290	141	111
90S	140	172	100	56	10X13	185	240	24	M8X20	50	8	20	90	M20X1.5	310	141	111
90L	140	172	125	56	10X13	185	240	24	M8X20	50	8	20	90	M20X1.5	335	141	111
100	160	196	140	63	12X15	205	260	28	M10X22	60	8	24	100	M20X1.5	367	141	111
100LB4	160	196	140	63	12X15	205	260	28	M10X22	60	8	24	100	M20X1.5	366	141	111
100LC4	160	196	140	63	12X15	205	260	28	M10X22	60	8	24	100	M20X1.5	388	141	111
63-112 B3 ▶ 6L																	
63	100	120	80	40	7X10	130	179	11	M4X10	23	4	8.5	63	M16X1.5	212	104	144
71	112	132	90	45	7X10	145	194	14	M5X12	30	5	11	71	M20X1.5	255	104	144
80	125	157	100	50	10X10	165	223	19	M6X16	40	6	15.5	80	M20X1.5	290	149	173
90S	140	172	100	56	10X13	185	240	24	M8X20	50	8	20	90	M20X1.5	335	149	173
90L	140	172	125	56	10X13	185	240	24	M8X20	50	8	20	90	M20X1.5	365	130	173
100	160	196	140	63	12X15	205	260	28	M10X22	60	8	24	100	M20X1.5	420	150	193
100LA4	160	196	140	63	12X15	205	260	28	M10X22	60	8	24	100	M20X1.5	400	150	193
100LB4	160	196	140	63	12X15	205	260	28	M10X22	60	8	24	100	M20X1.5	400	150	193
100LC4	160	196	140	63	12X15	205	260	28	M10X22	60	8	24	100	M20X1.5	420	150	193
112	190	222	140	70	12X15	230	295	28	M10X22	60	8	24	112	M25X1.5	431	150	193

56-112 B5

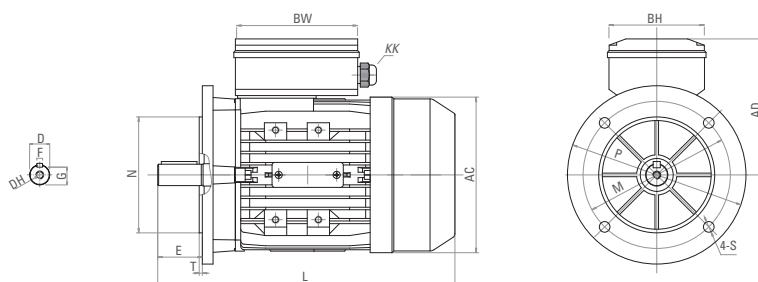
**B5**

	P	M	N	S	T	AC	AD	D	DH	E	F	G	H	KK	L	BW	BH
56-100 B5 ▶ 6M																	
56	120	100	80	7	3	115	100	9	M3X8	20	3	7.2	56	M16X1.5	192	116	92
63	140	115	95	10	3	130	116	11	M4X10	23	4	8.5	63	M16X1.5	212	116	92
71	160	130	110	10	3.5	145	123	14	M5X12	30	5	11	71	M20X1.5	240	116	92
80	200	165	130	12	3.5	165	143	19	M6X16	40	6	15.5	80	M20X1.5	290	141	111
90S	200	165	130	12	3.5	185	150	24	M8X20	50	8	20	90	M20X1.5	310	141	111
90L	200	165	130	12	3.5	185	150	24	M8X20	50	8	20	90	M20X1.5	335	141	111
100	250	215	180	15	4	205	160	28	M10X22	60	8	24	100	M20X1.5	367	141	111
63-112 B5 ▶ 6L																	
63	140	115	95	10	3	130	116	11	M4X10	23	4	8.5	63	M16X1.5	212	104	144
71	160	130	110	10	3.5	145	123	14	M5X12	30	5	11	71	M20X1.5	255	104	144
80	200	165	130	12	3.5	165	143	19	M6X16	40	6	15.5	80	M20X1.5	290	149	173
90S	200	165	130	12	3.5	185	150	24	M8X20	50	8	20	90	M20X1.5	335	149	173
90L	200	165	130	12	3.5	185	150	24	M8X20	50	8	20	90	M20X1.5	365	149	173
100	250	215	180	15	4	205	160	28	M10X22	60	8	24	100	M20X1.5	420	150	193
112	250	215	180	15	4	230	183	28	M10X22	60	8	24	112	M25X1.5	431	150	193

56÷112

56-112 B14

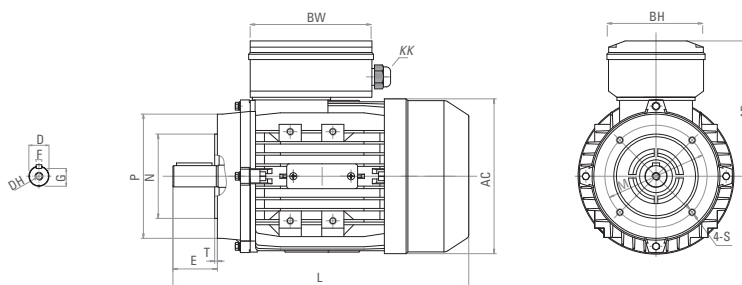

B14

	P	M	N	S	T	AC	AD	D	DH	E	F	G	H	KK	L	BW	BH
56-100 B14 ▶ 6M																	
56	80	65	50	M5	2.5	115	100	9	M3X8	20	3	7.2	56	M16X1.5	192	116	92
63	90	75	60	M5	2.5	130	116	11	M5X10	23	4	8.5	63	M16X1.5	212	116	92
71	105	85	70	M6	2.5	145	123	14	M5X12	30	5	11	71	M20X1.5	240	116	92
80	120	100	80	M6	3	165	143	19	M6X16	40	6	15.5	80	M20X1.5	290	141	111
90S	140	115	95	M8	3	185	150	24	M8X20	50	8	20	90	M20X1.5	310	141	111
90L	140	115	95	M8	3	185	150	24	M8X20	50	8	20	90	M20X1.5	335	141	111
100	160	130	110	M8	3.5	205	160	28	M10X22	60	8	24	100	M20X1.5	367	141	111
63-112 B14 ▶ 6L																	
63	90	75	60	M5	2.5	130	116	11	M4X10	23	4	8.5	63	M16X1.5	212	104	144
71	105	85	70	M6	2.5	145	123	14	M5X12	30	5	11	71	M20X1.5	255	104	144
80	120	100	80	M6	3	165	143	19	M6X16	40	6	15.5	80	M20X1.5	290	149	173
90S	140	115	95	M8	3	185	150	24	M8X20	50	8	20	90	M20X1.5	335	149	173
90L	140	115	95	M8	3	185	150	24	M8X20	50	8	20	90	M20X1.5	365	149	173
100	160	130	110	M8	3.5	205	160	28	M10X22	60	8	24	100	M20X1.5	420	150	193
112	160	130	110	M8	3.5	230	183	28	M10X22	60	8	24	112	M25X1.5	435	150	193

Nota: Fino al MEC71 incluso la flangia B14 standard ha 8 fori di fissaggio

Note: up to MEC71 included, the standard B14 flange has 8 mounting holes